





AT2303

KV1500



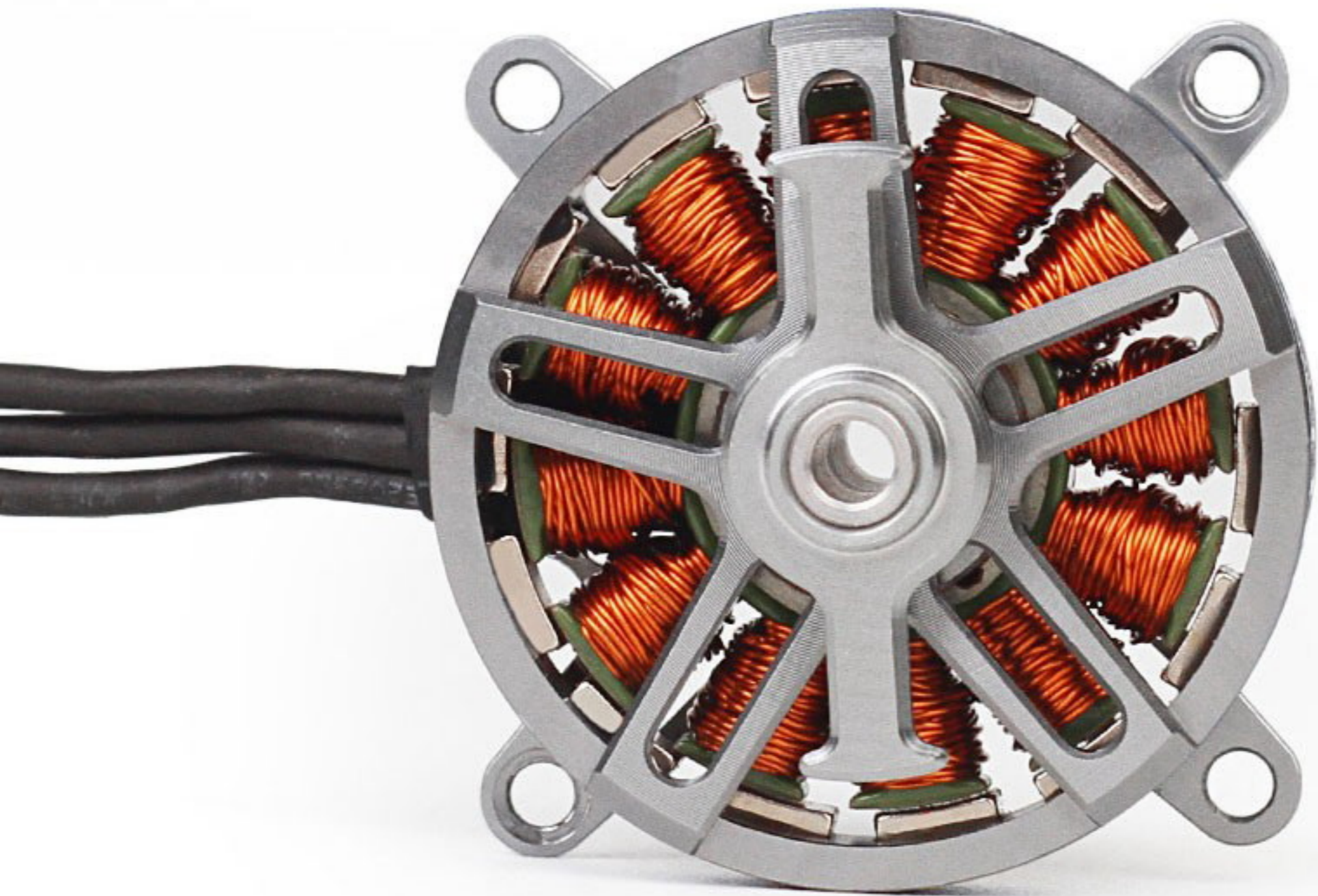



Type	Propeller	Throttle	Voltage (V)	Current (A)	Power (W)	RPM	Torque (N*m)	Thrust (g)	Efficiency (g/W)	Operating Temperature (°C)
AT2303 KV1800 Short Shaft	GWS 8040	40%	7.73	1.42	10.79	4426	0.012	100	9.23	52 (Ambient Temperature:/)
		45%	7.72	1.70	12.98	4760	0.013	116	8.93	
		50%	7.70	2.03	15.50	5106	0.015	133	8.60	
		55%	7.68	2.46	18.78	5513	0.018	155	8.25	
		60%	7.65	2.95	22.45	5905	0.020	178	7.94	
		65%	7.62	3.52	26.73	6287	0.023	204	7.62	
		70%	7.59	4.11	31.08	6613	0.025	225	7.23	
		75%	7.55	4.78	35.99	6952	0.028	251	6.96	
		80%	7.51	5.50	41.20	7282	0.031	275	6.68	
		90%	7.43	7.08	52.46	7865	0.036	323	6.15	
	100%	7.41	7.71	56.97	8077	0.038	338	5.94		
	GWS 9050	40%	7.71	1.67	12.77	3545	0.015	112	8.81	63 (Ambient Temperature:/)
		45%	7.69	2.05	15.67	3848	0.018	132	8.40	
		50%	7.66	2.57	19.57	4178	0.021	155	7.94	
		55%	7.63	3.20	24.27	4471	0.025	185	7.61	
		60%	7.59	3.90	29.45	4820	0.028	211	7.17	
		65%	7.55	4.70	35.35	5096	0.032	238	6.74	
		70%	7.51	5.47	40.98	5349	0.035	263	6.42	
		75%	7.47	6.33	47.18	5567	0.038	287	6.09	
		80%	7.43	7.20	53.31	5770	0.041	312	5.85	
90%		7.32	9.04	66.07	6131	0.046	351	5.32		
100%	7.29	9.61	69.96	6253	0.047	360	5.15			

Note: Motor temperature is motor surface temperature @100% throttle running 3mins.

(Date above based on benchtest are for reference only, comparion with that of other motor types is not recommended.)

Test Item	KV1800 Short Shaft	Weight (Incl. Cable)	18g
Motor Dimensions	Φ28*16.5mm	Internal Resistance	236mΩ
Lead	Enameled Wire 40mm	Configuration	12N14P
Shaft Diameter	IN:4mm OUT:3mm	Rated Voltage(Lipo)	2S
Idle Current(10V)	0.5A	Peak Current(180s)	10A
Max. Power(180s)	70W	Recommendation	10-15A+GWS8040/9050

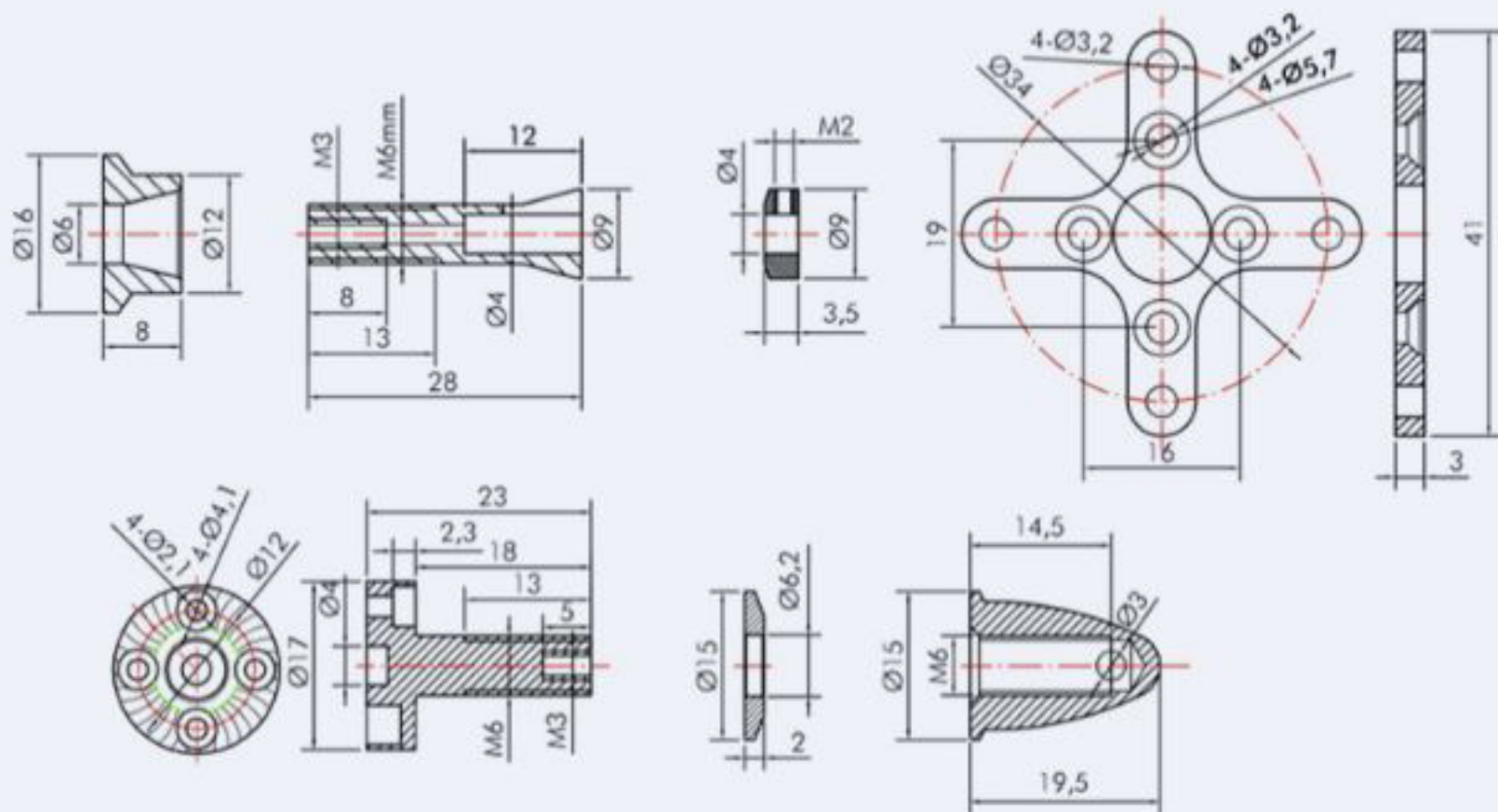
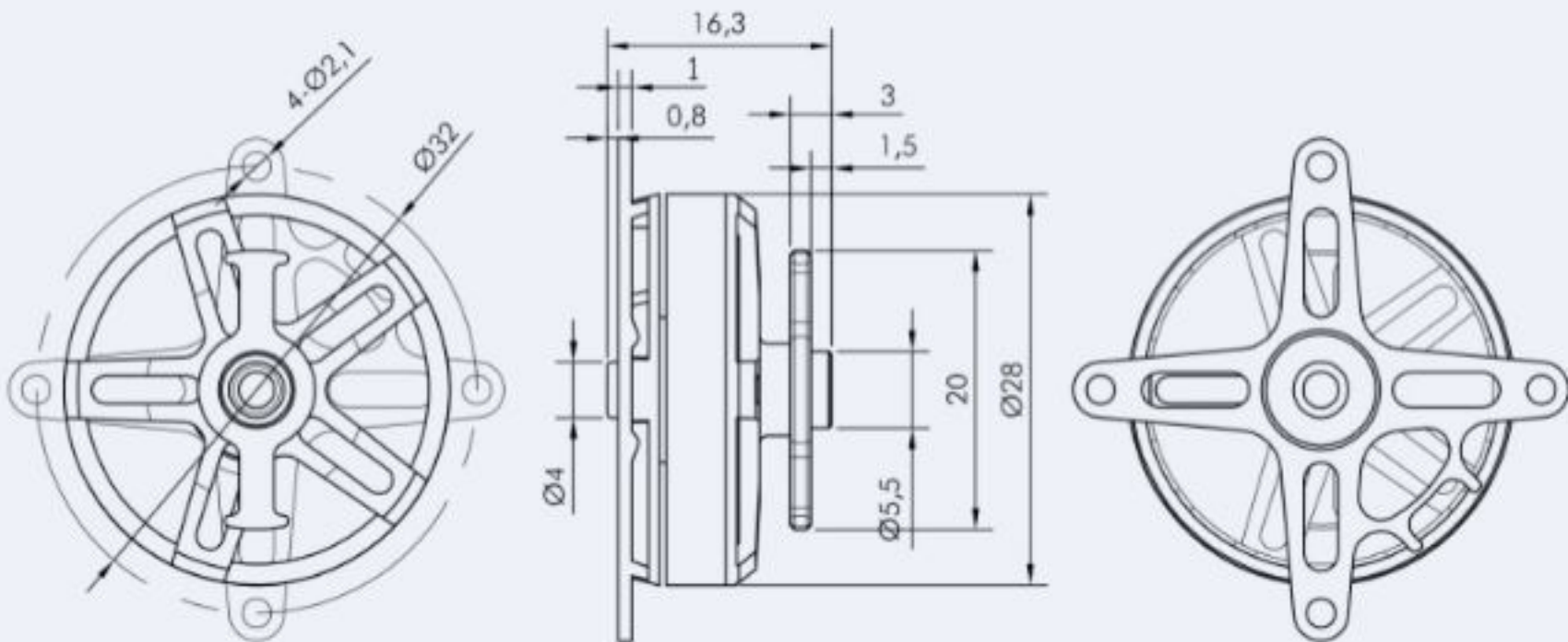

Contents



Motor×1



Parts Bag×1

(2.0*20mm O ring*2, M2*5mm cross self tapping screw*4
10*5.5*7*2.5mm Aluminum Prop Adapter*1
10*5.5*8*2.5mm Aluminum Prop Adapter*1)